

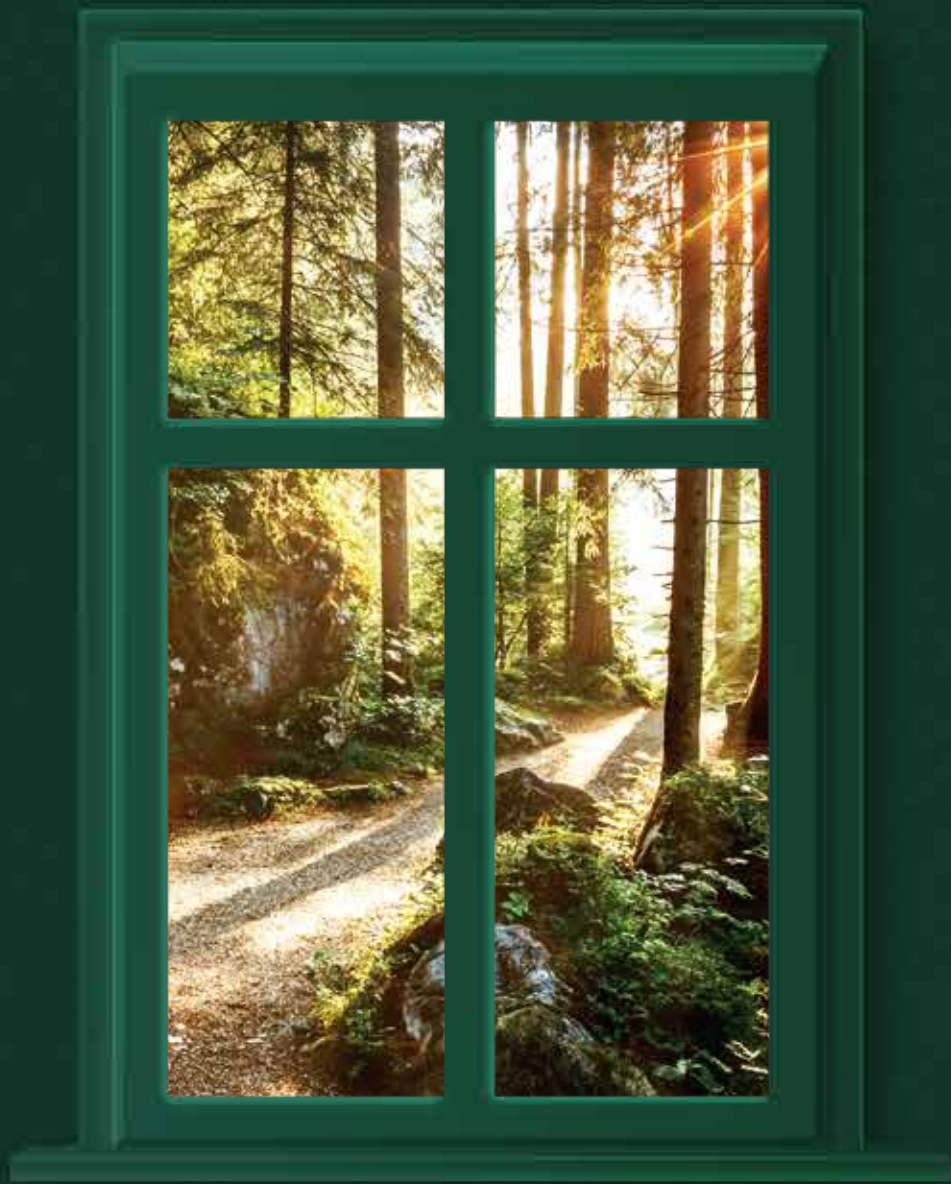

SOBHA

PASSION AT WORK



SOBHA
Ridge

Whispering Hill

Move In With Nature

Harmonious Living on a Hilltop

Imagine sipping your morning coffee surrounded by the symphony of birdsong or night-time stargazing as the cheery bonfire blazes beside you. More than just a space, it's a story waiting to unfold!

Presenting SOBHA Ridge – nature-rich luxurious hilltop 3, 3.5 & 4 BHK residences with panoramic views. These abodes are intricately crafted to maintain natural contours, offering 80% open space in 2.43 acres of scenic beauty.





Hiking Trail



Sunrise Deck



Miyawaki Forest

360° Open Living Concept

Discover a one-of-a-kind living experience in a verdant open space amidst lush greenery. The project is speckled by an array of outdoor amenities such as Biodiverse Miyawaki Forest, Multi-sport Ground, Sunrise Deck, Hiking Trail, Yoga Terrace, Camping Park & Picnic Plaza, among others which give this sprawling expanse a mesmerising aura. Move in with nature and savour a refreshingly therapeutic lifestyle.

Tranquility Lies Within

Step into the L-shaped living and dining room, bathed in the glow of natural light and enveloped by a gentle breeze. Your private sanctuary, the bedroom, is meticulously designed to harmonise with the surrounding natural elements, featuring a bay window with the most pristine views.

The kitchen, a testament to ergonomic excellence, is replete with urban conveniences. Welcome to a lifestyle where immersing yourself in nature is not merely a wellness activity, but a truly transformative experience.



L-shaped Living & Dining Room



Bedroom with scenic views

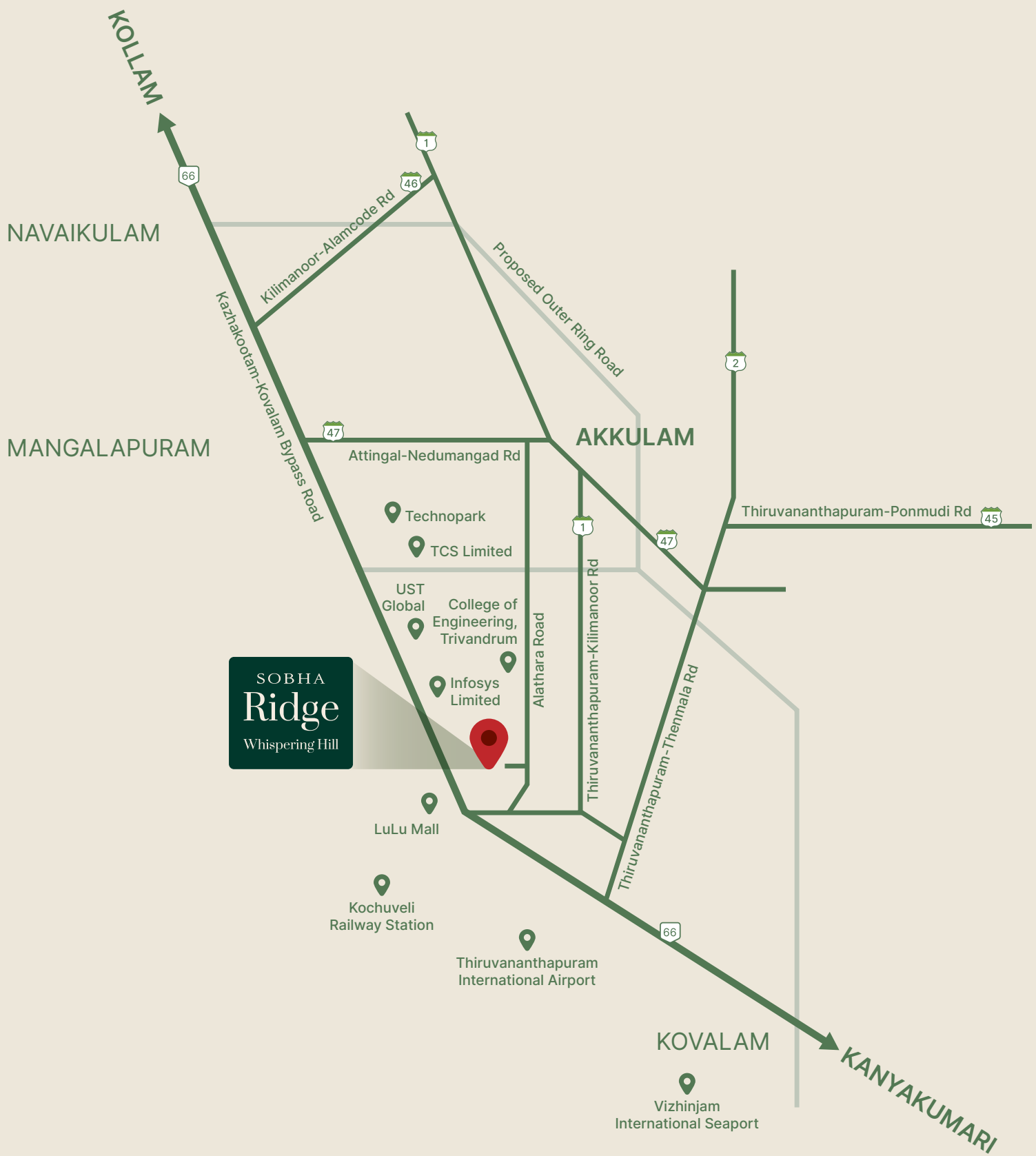

Akkulam - The Growth Corridor of the City

Akkulam is a highly sought-after destination with seamless connectivity, as it hosts Infosys, TCS, UST Global, and Technopark, one of India's largest tech parks with close to 72,000* IT professionals. The proposed 80 km-6-lane Outer Ring Road (ORR) is conveniently located 4.1 km from SOBHA Ridge.

*Source: Technopark official website

SOBHA Ridge - Well-connected Neighbourhood

It is not just a locale with scenic views and a serene ambience but is extremely well-connected.

The neighbourhood is close to the city centre, yet away from the bustle - with schools, colleges, hospitals, malls, IT hubs and the International Airport in close proximity.

SOBHA Ridge Whispering Hill

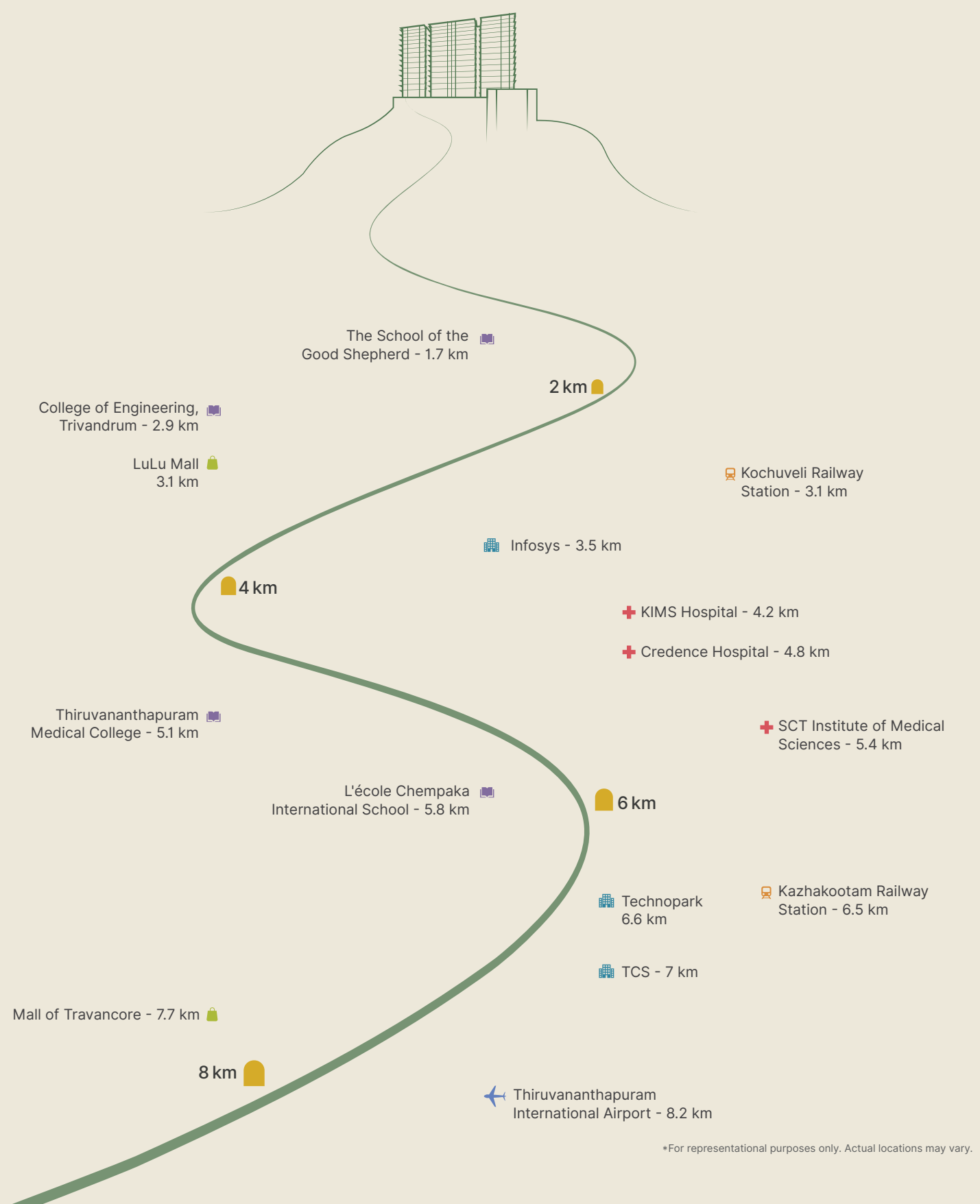

*For representational purposes only. Actual locations may vary.

Masterfully Crafted

- Seamlessly integrated with natural contours and panoramic views.
- Sports facilities and play areas are strategically located away from residential blocks.

Project Area: 2.43 acres

Total Units: 110

No. of Floors: B+S+G+13

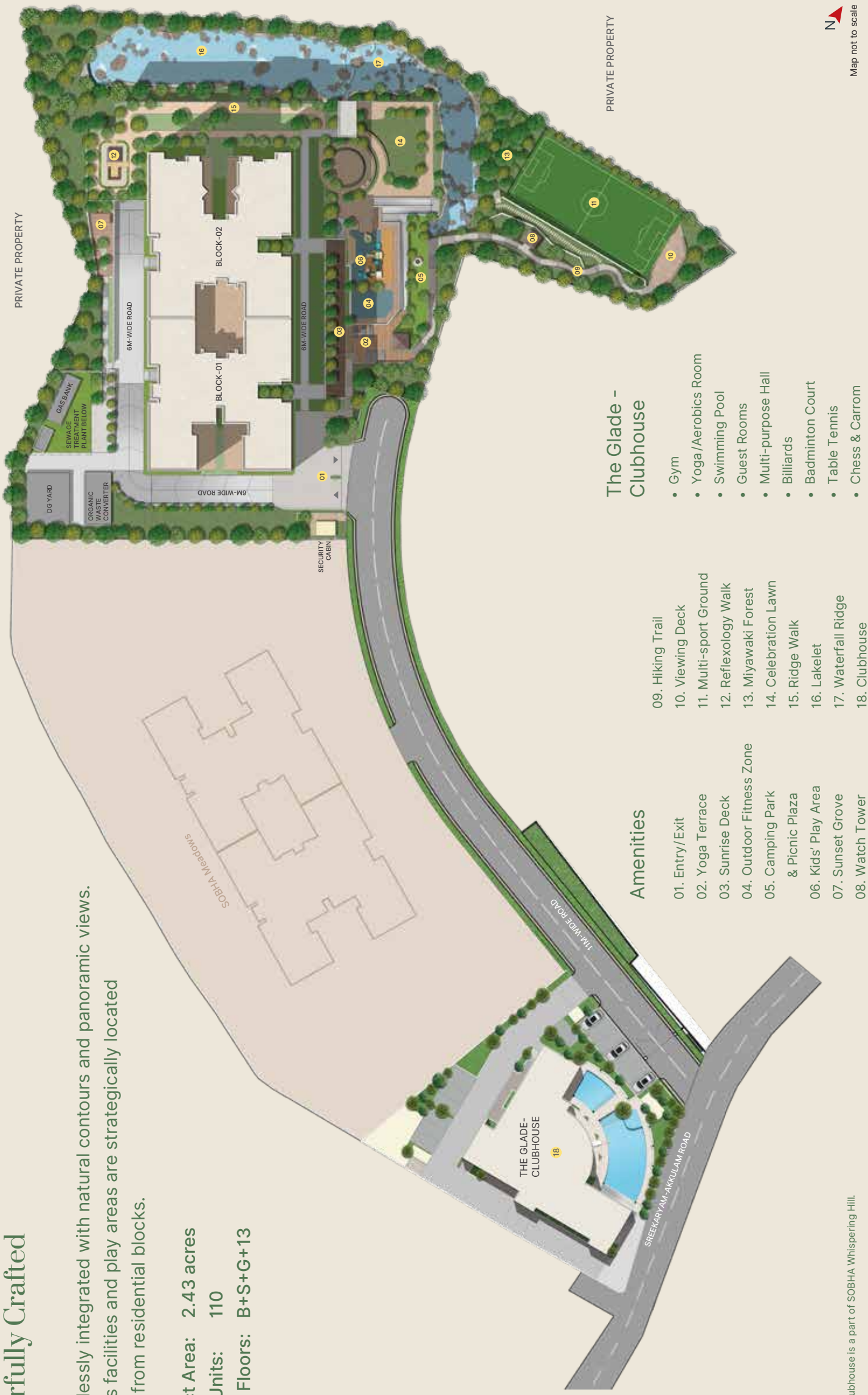

The Glade - Clubhouse

- Gym
- Yoga /Aerobics Room
- Swimming Pool
- Guest Rooms
- Multi-purpose Hall
- Billiards
- Badminton Court
- Table Tennis
- Chess & Carrom

Amenities

- 01. Entry/Exit
- 02. Yoga Terrace
- 03. Sunrise Deck
- 04. Outdoor Fitness Zone
- 05. Camping Park & Picnic Plaza
- 06. Kids' Play Area
- 07. Sunset Grove
- 08. Watch Tower
- 09. Hiking Trail
- 10. Viewing Deck
- 11. Multi-sport Ground
- 12. Reflexology Walk
- 13. Miyawaki Forest
- 14. Celebration Lawn
- 15. Ridge Walk
- 16. Lakelet
- 17. Waterfall Ridge
- 18. Clubhouse

*The Glade - Clubhouse is a part of SOBHA Whispering Hill.



K-RERA/PRJ/TVM/012/2024 | rera.kerala.gov.in

SOBHA Ridge - Whispering Hill, Akkulam, Thiruvananthapuram, Kerala 695017

☎ 080 4646 4510 ✉ marketing@sobha.com

DISCLAIMER: This document is conceptual and not a legal offering by the Company for advertising and is to be used for general information only. Any interested party should verify all the information including designs, plans, specifications, facilities, features, payment schedules, terms of sales, etc. independently with the Company prior to concluding any decision for buying in any of the project. The user of the Brochure confirms that he / she has not solely relied on this information for making any booking / purchase in any project of the Company. The visuals and information contained herein marked as "artistic impression" are artistic impressions being indicative in nature and are for general information purposes only. The visuals contained marked as "generic image" and other visuals / image / photographs are general images and do not have any correlation with the project. The imagery used on the brochures may not represent actuals or may be indicative of style only. Photographs of interiors, surrounding views and location may not represent actuals or may have been digitally enhanced or altered. These photographs may not represent actuals or may be indicative only. Computer generated images, walkthroughs and render images are artist's impressions and are an indicative of the actual designs. No information given on this brochure creates a warranty or expand the scope of any warranty that cannot be disclaimed under the applicable laws. The information on this brochure is presented as general information and no representation or warranty is expressly or impliedly given as to its accuracy. While enough care is taken by the Company to ensure that information in the brochure are up to date, accurate and correct, the readers / users are requested to make an independent enquiry with the Company before relying upon the same. Nothing in the brochure should be misconstrued as advertising, marketing, booking, selling or an offer for sale or invitation to purchase a unit in any project by the Company. The Company is not responsible for the consequences of any action taken by the viewer relying on such material / information in this brochure without independently verifying with the Company. *The Glade - Clubhouse is a part of Whispering Hill.

sobha.com